

Clinical Female Pelvic Trainer (CFPT) Mk 3 - Advanced



Designed and manufactured by Limbs & Things Limited,
Sussex Street, St. Philips, Bristol, BS2 0RA, UK.
Telephone: +44 (0)117 311 0500 Fax: +44 (0)117 311 0501
sales@limbsandthings.com www.limbsandthings.com

Issue 2, March 2011
© 2011 Limbs & Things

For more skills training products visit

www.limbsandthings.com

Clinical Female Pelvic Trainer (CFPT) Mk 3 - Advanced

Part No: **60905**

In response to customer feedback, the new CFPT Mk 3 has been designed with three major improvements in mind:

- greater durability: new materials are harder wearing
- simplified design: model is easy to disassemble and uterine modules are quickly and easily changed (no clips or screws)
- greater variety of modules: each with a different combination of uterine & cervical anatomical variations, and additional pathologies

Presents accurate anatomical and tactile representation of the female pelvis for hands-on examination and diagnosis of pathologies and abnormalities. It can be used for many levels of training from undergraduate onwards, as well as family health.

Skills

- Recognition of perineal and pelvic anatomy including bony landmarks
- Digital vaginal examination
- Bi-manual examination
- Cervical smear procedure (including use of speculum)
- Digital rectal examination

Features & Improvements

- Interchangeable uterine modules with different complications are available (*order separately*)
- Modules can be changed quickly and easily
- Each uterus is presented at the correct anatomical angle
- Each cervix is more pronounced, as in real life
- Soft and strong perineum & labia
- Labia can be parted more realistically
- Anus and lower bowel is present in all Modules
- Abdominal wall with fat layer makes palpation more realistic
- Abdominal wall can be removed quickly and easily
- Partial thighs aid anatomical orientation
- Water-based lubricant supplied to aid digital examination and use of speculum
- Modules can be easily cleaned to remove lubricant
- All components are latex free

Package supplied

- | | |
|-------------------------------------------------------|------------------------------------------------|
| • 1 CFPT Mk 3 - Standard Part No: 60900 | |
| • 1 CFPT Module 2 Part No: 60921 | • 1 CFPT Module 5 Part No: 60924 |
| • 1 CFPT Module 3 Part No: 60922 | • 1 CFPT Module 6 Part No: 60925 |
| • 1 CFPT Module 4 Part No: 60923 | • 1 CFPT Module 7 Part No: 60926 |

Components



CFPT Abdominal Insert

Part No: **60910**

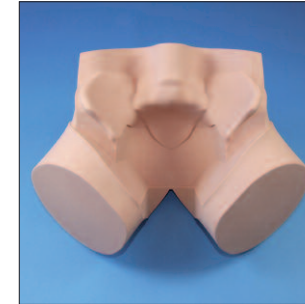

Lower torso

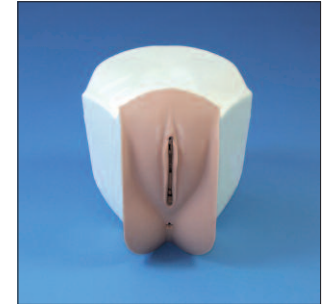

CFPT Module 1
CFPT Module 2
CFPT Module 3
CFPT Module 4
CFPT Module 5
CFPT Module 6
CFPT Module 7

See the Guide at the back for more information on the Modules



Base

IMPORTANT

Only palpate the Module when the abdomen is correctly fitted over it. Not doing so may tear the foam on the top of the Module, which will invalidate the warranty.



Setting up the CFPT Mk 3

1



Place the base onto the work surface.

Position the torso on the base.

2

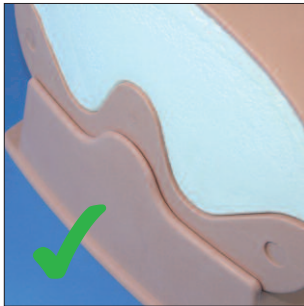

Check that the torso is fully pushed up against the wall at the back of the base.

The Trainer is ready to use.

Changing the uterus Module

1

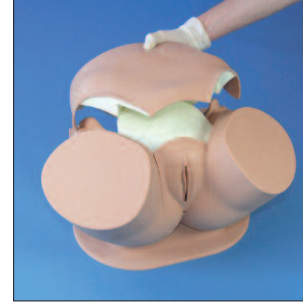

The easiest way to remove the Abdominal Insert is to lift it up from the back of the Trainer.

2



Lift the Module out using both hands (one at the front and the other at the back).

Do not try and remove the Module using only one hand: this distorts the foam and makes the Module difficult to remove.

Reverse the procedure to refit both the Module and the Insert.

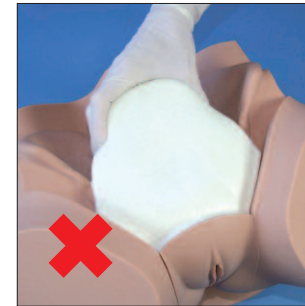

Guide to CFPT Uterus Modules:

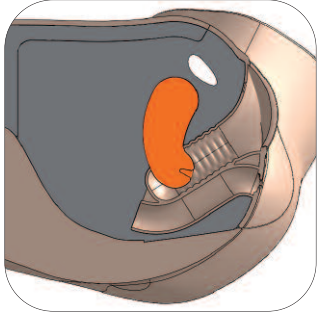

**CFPT Module 1:
Normal - Nulliparous Cervix**

Part No: **60920**

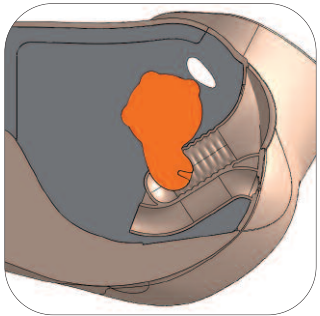

**CFPT Module 2:
Large Fibroid - Nulliparous Ectropion Cervix**

Part No: **60921**

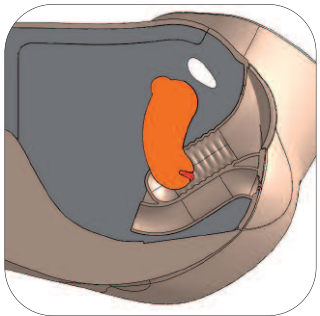

**CFPT Module 3:
Small Fibroid - Nulliparous Polyp Cervix**

Part No: **60922**

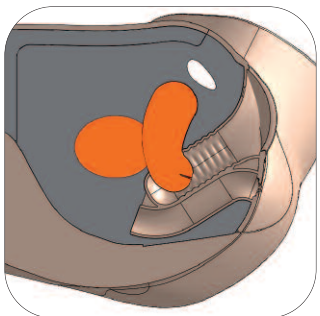

**CFPT Module 4:
Ovarian Cyst - Multiparous Cervix**

Part No: **60923**

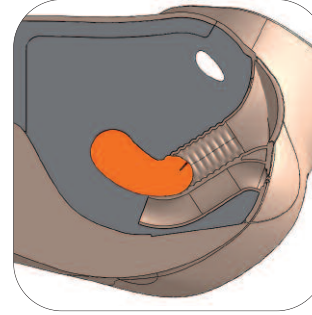

**CFPT Module 5:
Retroverted - Multiparous Cervix**

Part No: **60924**

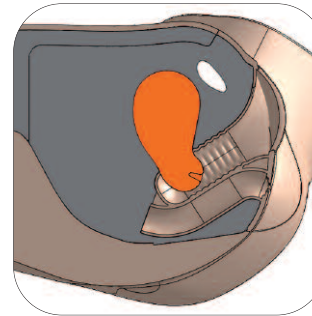

**CFPT Module 6:
10-12 Weeks Pregnant**

Part No: **60925**

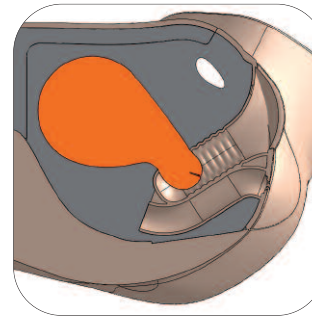

**CFPT Module 7:
14-16 Weeks Pregnant**

Part No: **60926**